

Motion Sensor Installation Guide

Procedure to Install Motion Sensor



INSTALLATION

This procedure shows you how to install a Motion Sensor.

Complete the following steps (in order) to correctly install the Motion Sensor:

1. Install battery.
NOTE: When batteries are first installed, the sensor automatically goes into pairing mode. Refer to the Room Controller pairing procedure for commissioning.
2. Remove plastic pull tab.
3. Verify device. Refer to "Verify Sensing Motion" on page <?>.
4. Install Motion Sensor.

Location

Always consider the following location constraints before installing Motion Sensor:

1. Do not install on outside wall.
2. Do not install in areas with direct heat source.
3. Do not install near any air discharge grill.
4. Do not install in areas exposed to direct sunlight.
5. Ensure surface is flat and clean.

Sensor Placement

Orient Motion Sensor for best use of its detection zones according to below illustration.

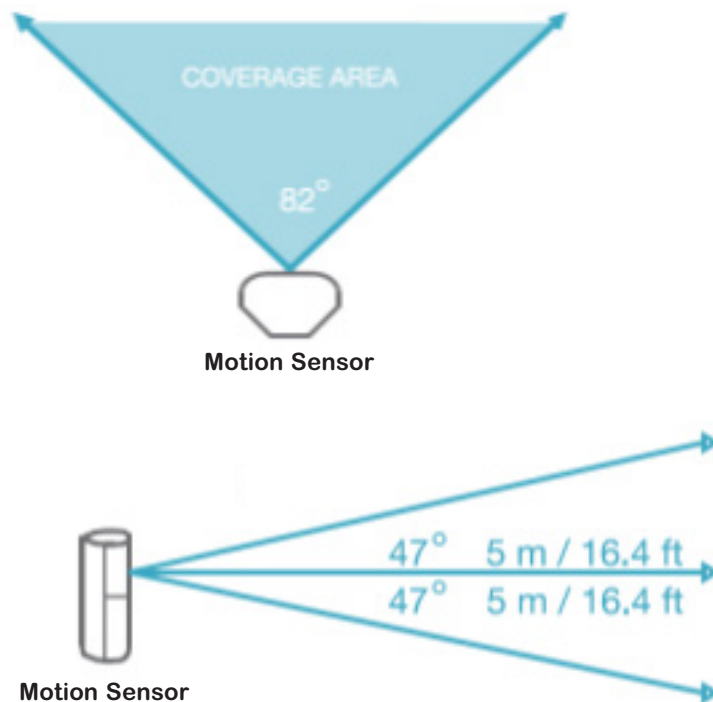

* All Measurements are approximate.

INSTALL BATTERY

1. Using flathead screwdriver, gently pry cover away from Motion Sensor (Figure 1).
 2. Remove any packing tape from inside Motion Sensor.
 3. Install one CR2 in Motion Sensor (Figure 2).
- NOTE:** ensure battery polarity is correct.
4. Verify sensing motion. Refer to "Verify Sensing Motion" on page <?>.



Figure - 1

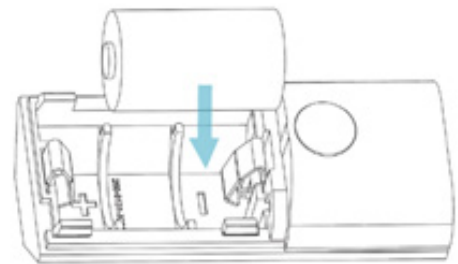

Figure - 2

VERIFY SENSING MOTION

1. Allow three minutes to pass for Motion Sensor to warm-up.

NOTE: Sensor requires a three minute warm-up time before it reports any motion detection.
 2. Wave hand or object over top area of Motion Sensor.
 3. Verify LED flashes red on Motion Sensor (Figure 3).
- NOTE:** LED flashing red indicates motion detected.
4. Snap battery cover back in place.
 5. Install Motion Sensor. Refer to "Install Motion Sensor" on page <?>.

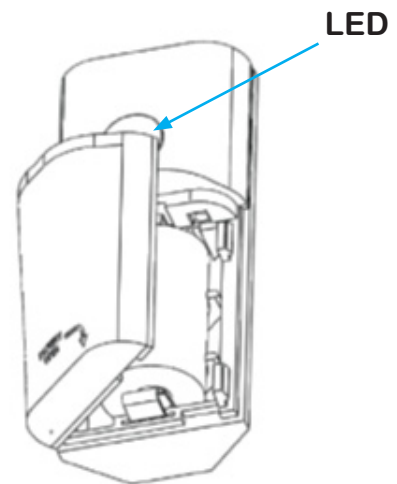

Figure 3

INSTALL MOTION SENSOR

This procedure shows you how to install the Motion Sensor to the desired location. The Motion Sensor can be installed vertically, horizontally, or upside down on a flat surface or in a corner.

1. Affix 2-sided tape to desired location (Figure 1).
2. **NOTE:** ensure tape is flush with surface and securely affixed to surface.
3. Set Motion Sensor on 2-sided tape and press firmly to secure Motion Sensor in place.
4. Test Motion Sensor. Refer to "Device Function" on page <?>.

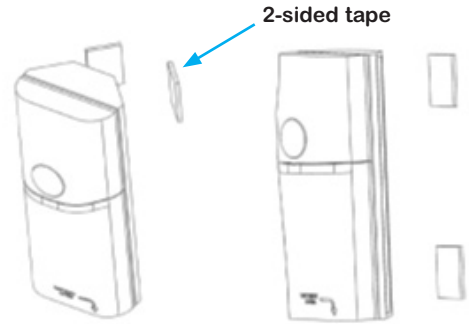
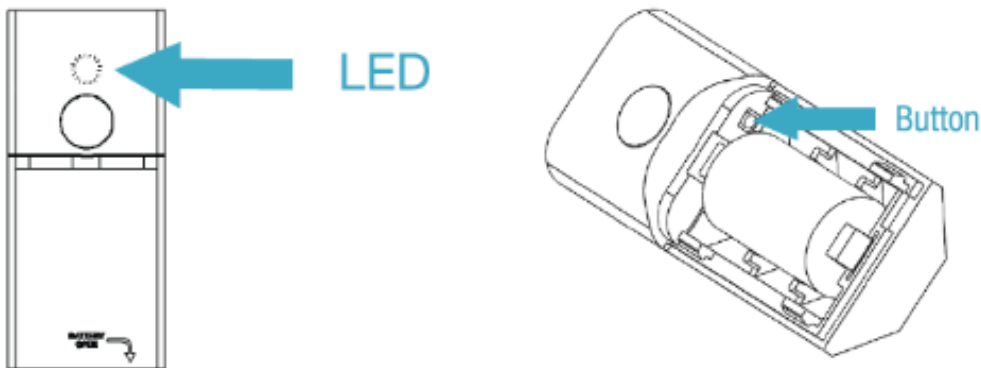

Figure 1



- Always test Device before leaving job site.
- Avoid installing Device directly on metal surfaces. Installation on metal can reduce transmission range.
- Ensure Device is installed in dry location away from water, moisture, and rain.

DEVICE FUNCTION



Function and LED Indicators				
BUTTON	LED	ACTION	LED	DESCRIPTION
2 times	●● GG	Network Status	●●● GGG	Joined
			●●● RRR	Not Joined
			●●● YYY	Re-Join in Process
4 Times	●●●● GGGG	Network Join	●●●● YYY	Searching for Network
			●●●● YGY	Device Being Configured
			●●●● GGG	Device Joined
			●●●● RRR	Device Failed to Join
8 Times	●●●●●●●● GGGGGGGG	Forced Re-Join	●●●● YYY	Re-Join, Searching for Parent
10 Times	●●●●●●●●●● GGGGGGGGGG	Network leave and join a new Network	●●●● RRR	Leave if Joined
			●●●●●●●● GGGGGG	Defaults Restored
G = Green Y = Yellow R = Red		No Action	● Y	Wrong Button Press
		Power Up	●●●● YGR	Device Busy
			●●●●●● RRYGG	