

Product End of Life Instructions

Insulation fault locator





Potential disassembly risks



End of Life Instructions

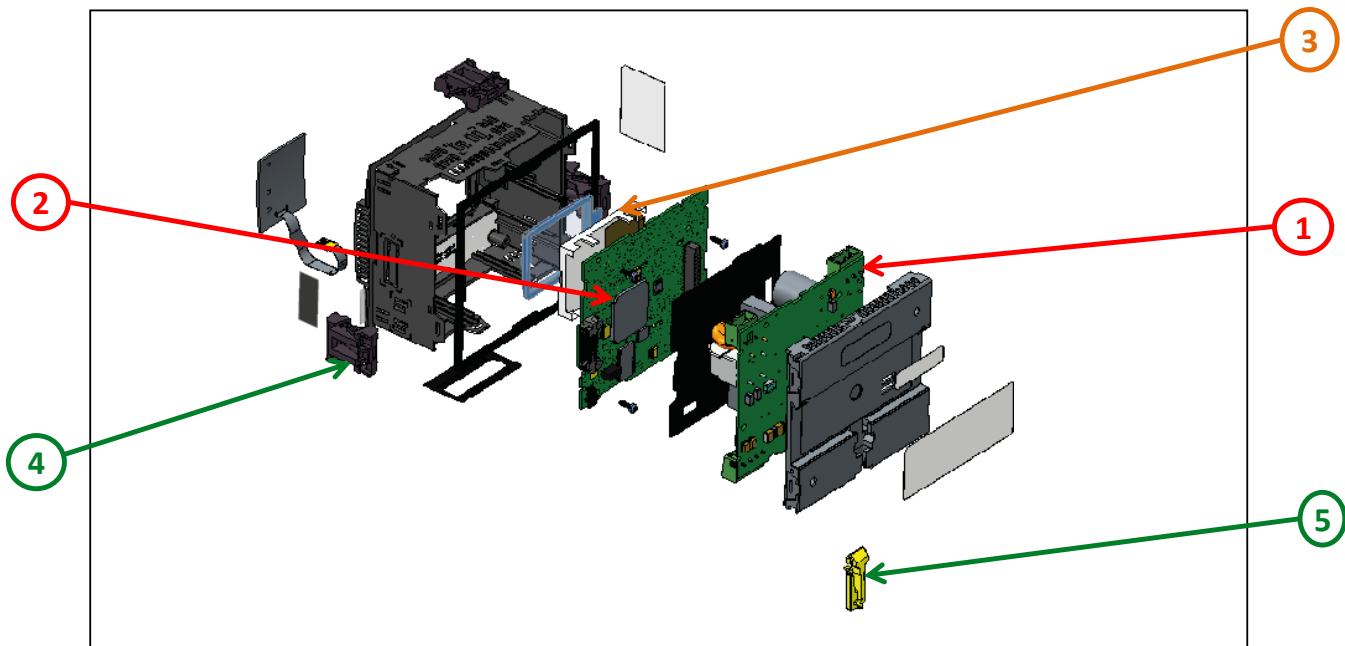

Recommendation	Number on drawing	Component / Material	Weight (in g)	Comment
To be depolluted	MFR36502	IFL12_PSU_PCBA_COMM_VIN_LVD C	116.99	1
To be depolluted	NVE92039	IFL_12_DIGITAL_WITH_LCD_PCBA	222.21	2
To be depolluted	NVE64486	OUREA HMI PSDB-1618 HIGH POLARIZER	15	3
To be dismantled	QGH63218	AC PLUG, 2 PIN, CONTROL POWER	4	4
To be dismantled	AAV31805	LOCKING CLIP	1.338	5



Product description

Manufacturer identification	Schneider Electric Industries SAS
Brand name	Schneider Electric
Product function	IFL is an insulation fault locating device with 12 channel for ungrounded power systems with isolated neutral.
Product reference	IMDIFL12LMC
Additional similar product references	IMDIFL12LMC IMDIFL12LMCT IMDIFL12MCN IMDIFL12L
Total representative product mass	352.93 g
Representative product dimensions	108mm x 96mm x 59mm
Accessories	Connectors
Date of information release	07/2019



Additional information

Legal information	The product family must be disposed according to the legislation of the country. This document is intended for use by end of life recyclers or treatment facilities. It provides the basic information to assure an appropriate end of life treatment for the components and materials of the product.	
Recyclability potential	13%	Based on "ECO'DEEE recyclability and recoverability calculation method" (version V1, 20 Sep. 2008 presented to the French Agency for Environment and Energy Management: ADEME).

Schneider Electric Industries SAS

Country Customer Care Center
<http://www.schneider-electric.com/contact>

35, rue Joseph Monier

CS 30323

F- 92506 Rueil Malmaison Cedex

RCS Nanterre 954 503 439

Capital social 896 313 776 €

www.schneider-electric.com

ENVEOLI1906004_V1

Published by Schneider Electric

© 2019 - Schneider Electric – All rights reserved

07/2019

)