

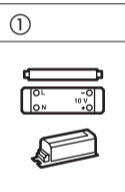
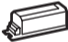

Remote dimmer 0 - 10 V

0 036 60

 **legrand**®

Technical data

| | ① | ② |
|--------|---|---|
| |  |  |
| 230 V~ | 1000 VA | 1000 VA |
| 110 V~ | 500 VA | 500 VA |

| | |
|---|--|
| Voltage | 100 - 240 V~ |
| Frequency | 50 - 60 Hz |
|  | 2 x 1.5 mm ² or 1 x 2.5 mm ² |
| Capacity | 4 modules |
|  | 0° C to + 45° C |

- ① Fluorescent tube with electronic ballast 0 - 10 V
② Ballast 0 - 10 V for controlling lighting LEDs

- Control current 0 - 10 V max. (sum of current supplied by the ballasts) : 50 mA
- Maximum inrush current on closing the contact with 230 V~ : 120 A - 20 ms

Description

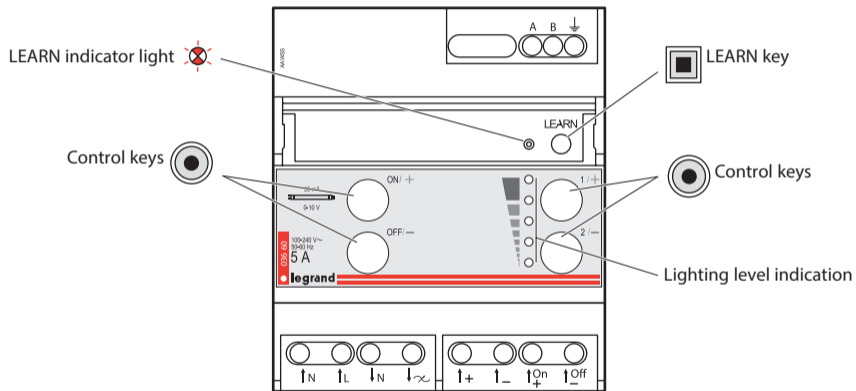

Safety instructions

This product should be installed preferably by a qualified electrician. Incorrect installation and use can entail risk of electric shock or fire.

Before carrying out the installation, read the instructions and take account of the product's specific mounting location.

Do not open up the device. All Legrand products must be opened and repaired only by personnel trained and approved by Legrand. Any unauthorised opening or repair completely cancels all liabilities and the rights to replacement and guarantees.

Only use Legrand brand accessories.

Factory set configuration

When first powering up, pressing on the ON or OFF keys controls all the remote dimmers cabled into the bus.

This facility is provided in order to check the correct functioning of all the lights.

A double press on the LEARN⁽¹⁾ key cancels this general control function.

⁽¹⁾Touche de programmation ou apprentissage.

Cabling

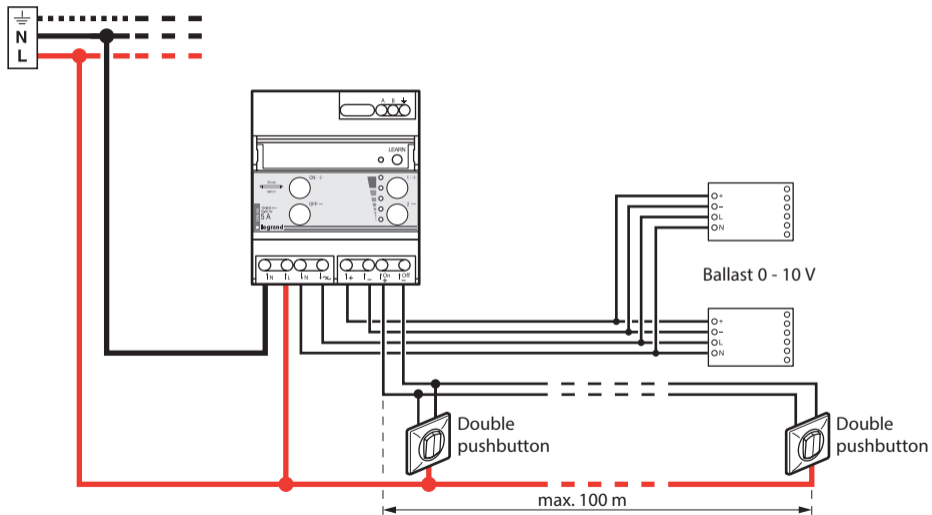

Cabling with single push-button

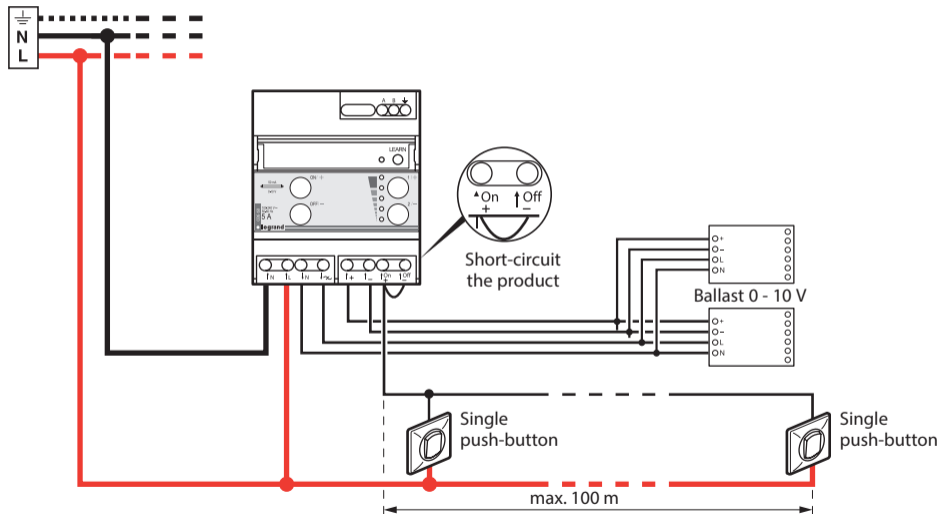

Local functioning

Action

Short press on the ON/+ key

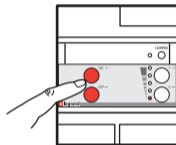

Short press on the OFF/- key

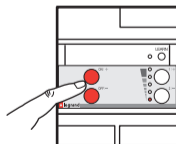

Long press on the ON/+ key

Long press on the OFF/- key

Ballast 0 - 10 V

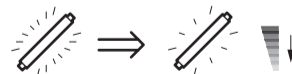
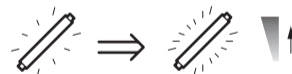
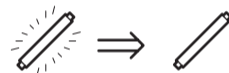

Local functioning *(continued)*

Action

Ballast 0 - 10 V

Short press on the 1/+ key

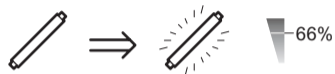
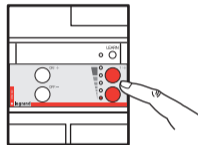

Short press on the 2/- key

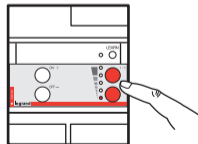

Long press on the 1/+ key

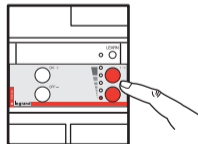

Long press on the 2/- key

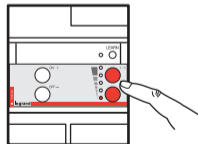

Customising the light level of keys 1 and 2 x

Action

L

From key 1/+

Adjustment of the light level required:

- By a long press on the ON/+ key
- By a long press on the OFF/- key

Saving:

- By pressing simultaneously on keys 1/+ and ON/+

The level of key 1/+ is then recorded

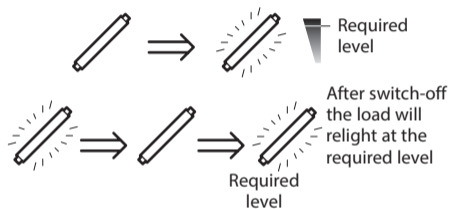
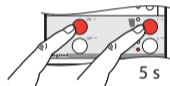
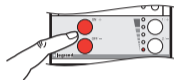

From key 2/-

Adjustment of the required light level:

- By a long press on the ON/+ key
- By a long press on the OFF/- key

Saving:

- By pressing simultaneously on keys 2/- and OFF/-

The level of key 2/- is then saved

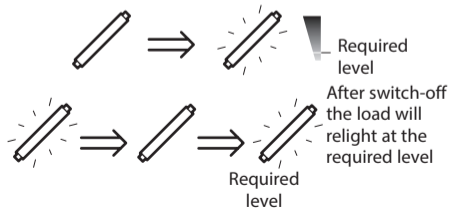
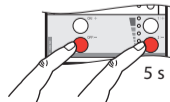
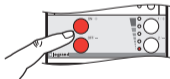

Customising the light level of keys 1 and 2 x (continued)

Action

L

Level memory

To activate level memory:
simultaneous long press on buttons OFF/- and 1/+

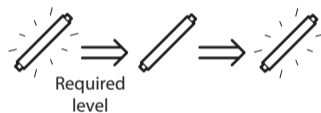
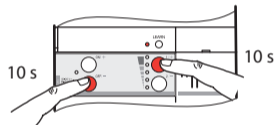





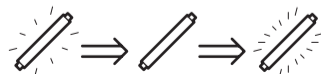
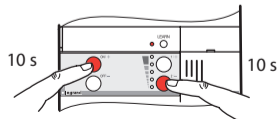



After switch-off,
the load will light up
again at the previous
level

To deactivate level memory:
simultaneous long press on buttons ON/+ and 2/-



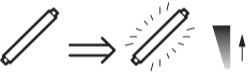









After switch-off,
the load will light up
again at the maximum
level

Push-button operation

| Action | L | Action | L |
|--|---|--|---|
|  Short press  |  | Appui long  |  |
| Short press  |  | Long press  |  |

Push-button operation (continued)

| L | Action | L | Action | L |
|---|---|---|--|---|
|  |  Short press  |  | Short press  |  |
|  | Long press  |  \Rightarrow  | | |

Resetting factory configuration

Action

Indicator light status

Remote dimmer transmitter:

Press the LEARN key

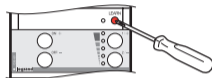

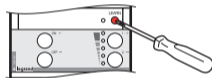

Press the LEARN key
and keep it pressed for 10 seconds



Legend

 The indicator light goes out

 The indicator light blinks slowly

 The indicator light blinks rapidly

 The indicator light flashes