

SpaceLogic™ Bluetooth® Adapter

Adapter

Regulatory Compliance and Safety Information

Electrical equipment should be installed, operated, serviced, and maintained only by qualified personnel. No responsibility is assumed by Schneider Electric for any consequences arising out of the use of this material. Carefully read these instructions and all information relevant for this product before trying to install it. See the list of technical literature. The technical literature and declarations of conformity can be accessed on the Schneider Electric Exchange website, ecobuilding.schneider-electric.com. Contact your local Schneider Electric sales office for a hard copy of the documentation or for additional information.

Technical Literature

- SpaceLogic Hardware Reference Guide, 04-XX001-XX-en

Removing the Protective Cap from the Adapter

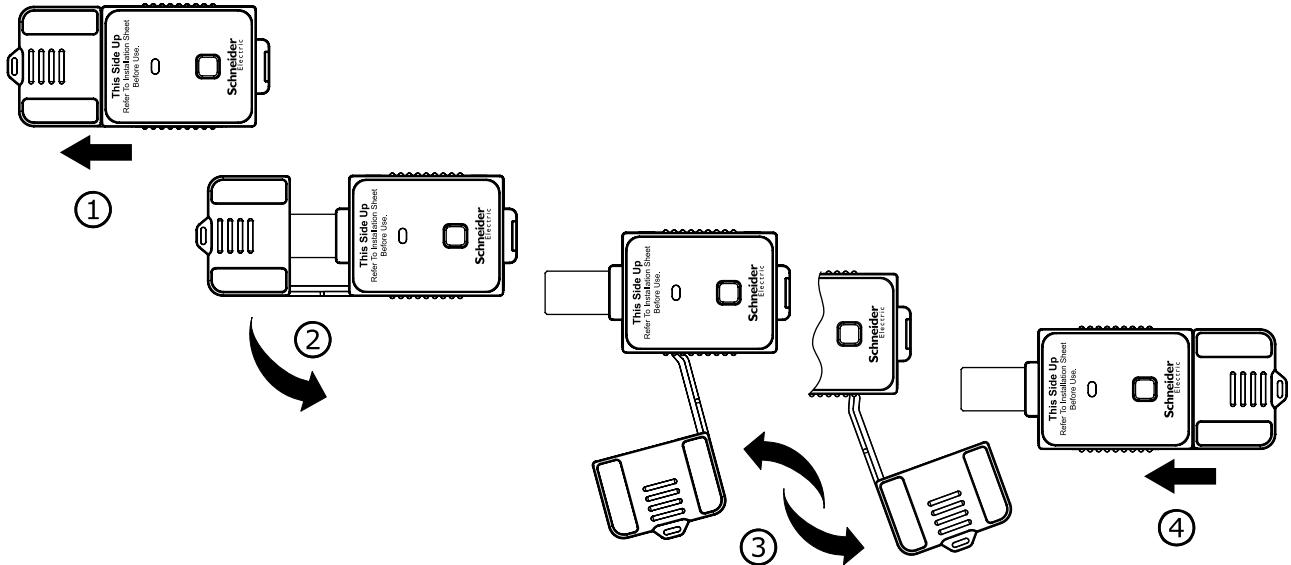

Attaching the Lanyard to the Adapter

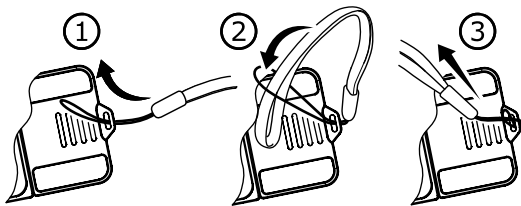

Installing the Adapter on a SpaceLogic Sensor

NOTICE	
SPACELOGIC SENSOR OR OTHER EQUIPMENT DAMAGE	
<ul style="list-style-type: none"> • Plug in with the button to the front. • Do not plug into any device other than a SpaceLogic Sensor. 	
Failure to follow these instructions can result in equipment damage.	

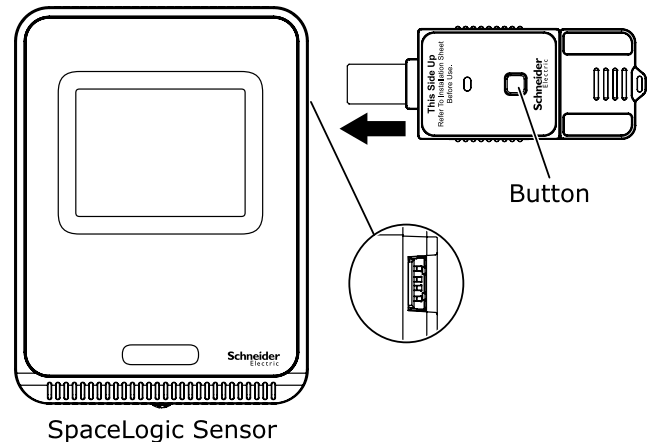

Pairing the Adapter with the EcoStruxure Building Commission Mobile Application

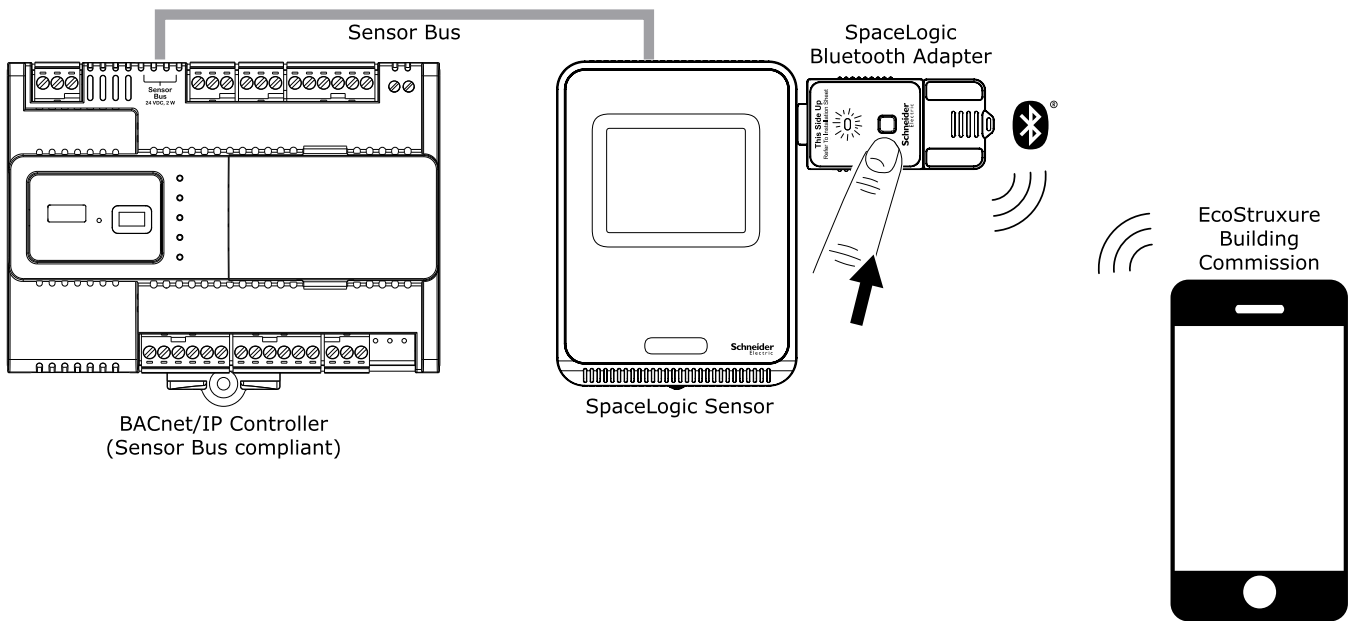

Part Numbers

Product	Part number
SpaceLogic Bluetooth® Adapter	SXWBTAECXX10001

Specifications

DC input	BACnet/IP controller communications RS-485, proprietary Sensor Bus protocol	Mechanical
Power consumption Maximum 0.25 W	Operation environment	Dimensions (W x H x D) 70 x 32 x 12 mm (2.8 x 1.3 x 0.5 in.)
Communications	Ambient temperature, operating 0 to 50 °C (32 to 122 °F)	Weight 0.02 kg (0.05 lb) with lanyard
Wireless communications Bluetooth® 4.2 Low Energy compliant Bluetooth® 5 Advertising Frequency: 2.4 GHz Line-of-sight range: max. 50 m (164 ft)	Humidity Maximum 95 % RH non-condensing	

Addendum - California Proposition 65 Warning Statement for California Residents

⚠ WARNING: This product can expose you to chemicals including lead which is known to the State of California to cause cancer and which is known to the State of California to cause birth defects or other reproductive harm. For more information go to www.P65Warnings.ca.gov

部件名称 (Part Name)	有害物质 (Hazardous Substances)					
	铅 (Pb)	汞 (Hg)	镉 (Cd)	六价铬 (Cr (VI))	多溴联苯 (PBB)	多溴二苯醚 (PBDE)
塑料部件 (Plastic Parts)	○	○	○	○	○	○
电子件 (Electronics)	X	○	○	○	○	○

本表格依据 SJ/T11364 的规定编制。(This table is made according to SJ/T 11364.)

○: 表示该有害物质在该部件所有均质材料中的含量均在 GB/T 26572 规定的限量要求以下。
(Indicates that the concentration of hazardous substance in all of the homogeneous materials for this part is below the limit as stipulated in GB/T 26572.)

X: 表示该有害物质至少在该部件的某一均质材料中的含量超出 GB/T 26572 规定的限量要求。
(Indicates that the concentration of hazardous substance in at least one of the homogeneous materials used for this part is above the limit as stipulated in GB/T 26572.)

Regulatory Notices

This equipment has been tested and found to comply with the limits for a Class B digital device, pursuant to part 15 of the FCC Rules. These limits are designed to provide reasonable protection against harmful interference in a residential installation. This equipment generates, uses and can radiate radio frequency energy and, if not installed and used in accordance with the instructions, may cause harmful interference to radio communications. However, there is no guarantee that interference will not occur in a particular installation. If this equipment does cause harmful interference to radio or television reception, which can be determined by turning the equipment off and on, the user is encouraged to try to correct the interference by one or more of the following measures: reorient or relocate the receiving antenna; increase the separation between the equipment and receiver; connect the equipment into an outlet on a circuit different from that to which the receiver is connected; consult the dealer or an experienced radio/TV technician for help.

Cet appareil est conforme à la norme RSS exempte de licence d'Industrie Canada. L'opération est sous réserve des deux conditions suivantes: (1) Cet appareil ne doit pas causer d'interférences; (2) Cet appareil doit accepter toute interférence fonctionnement indésirable de l'appareil

Explanatory documentation to be supplied with a device: If it is possible for a device to be installed or operated incorrectly, to the extent that the device will be used in a way that the device does not comply with an applicable standard for the device, the supplier of the device must supply documentation with the device that sets out specifications for correct installation and operation to minimize that possibility.