

## LED Flood Light Instruction

### ◆ Remote control key description

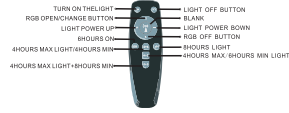

- The installation of solar panels should be direct sunlight as more as possible, without being blocked by buildings or trees, and ensure the longest acceptable irradiation time (the solar panels can not be installed under glass or indoors). Only by correctly and scientifically installing solar panels and it will have the best charging effect.
- If you need to inspect the lamp, first place the solar panel and lamp in a place with sufficient light, and connect the connection between the lamp and the solar panel. Cover the solar panel with opaque material, and the lamp will be light on. The solar panel can work normally and the battery can charge normally Electricity.

### ◆ Maintenance Instruction

- Clean the glass cover and solar panel of lamps regularly to keep good light transmittance of lamps.
- This product can not be disassembled without permission.
- Do not use any charger to charge this product.
- Be careful do not clean the lamps with water or corrosive solution, but rather with a dry rag.
- Under normal use conditions, quality assurance is based on the correct preservation, installation, use and maintenance of products. Product damage caused by improper installation and use and violation of product operation regulations is not within the scope of this guarantee. For the quality problems during the quality warranty period, the company will choose to repairing, repairing parts or replacing new products during the warranty period. If the warranty period exceeds, materials and labor costs will be properly charged. The product quality problems caused by natural factors and environmental factors are not covered by the warranty.

## LED Flood Light

CE RoHS

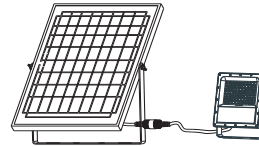

## Instruction

The product is suitable for many kinds of lighting places, such as courtyard, storefront, store, square, station, wharf, bridge, warehouse, etc.

LED Flood Light

## LED Flood Light Instruction

### ◆ Assembly drawing of product

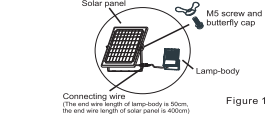

Figure 1

### ◆ Installation Instructions

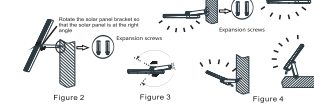

Figure 2

Figure 3

Figure 4

### Accessories list



- The lamp can be installed on the wall or on the lamp pole.

- As shown in figure 2 below, install the solar panel on the wall and rotate the solar panel bracket to make the solar panel at an appropriate angle. Let the solar panel receive direct sunlight as far as possible and not be obstructed by buildings or trees. The best charging effect can be achieved only when the solar panel is installed correctly and scientifically to ensure the longest irradiation time (the solar panel must not be installed under the glass or indoors).
- As shown in figure 3, the lamp bracket can be installed at 260°. The customers can install the lamps at different angles according to their actual needs to meet the lighting needs of different scenes, as shown in figure 4.
- After installation, connect the power line of the lamp and solar panel through the built joint. Ensure that the joint is fully connected to ensure the waterproof effect of the whole lamp. The lamp end of the conventional power wire is 50cm, and the solar panel end is 400cm. It can also be customized according to the needs of customers.

### ◆ Instruction manual

- As shown in the figure, after installing the remote control battery, press the "ON" button of the remote control to turn on the lamp, and press the "OFF" button to turn off the lamp. You can also press other buttons to enter other working modes of lamps and lanterns. The functions and functions of various working modes corresponding to lamps and lanterns and remote control system and buttons on remote control will be described in detail later.
- After debugging or inspecting the lamp, it is necessary to press "Auto" to make the lamp control system return to the normal working mode.
- The surface of the lamp and solar energy is made of glass, which is fragile. Please handle it with care during storage and transportation.
- This lamp should be stored in a place with good air circulation and less dust. The ambient temperature should be between -10 °C and 40 °C, and it should not be stored in icy environment. Keep away from corrosive substances, stay idle for a long time, and need to charge and discharge once a month.