

item number	width (A) (mm)
<b>SR 60X25_S</b> <b>SR 60X25_F</b>	26
<b>SR 60X50_S</b> <b>SR 60X50_F</b>	51
<b>SR 60X75_S</b> <b>SR 60X75_F</b>	76
<b>SR 60X100_S</b> <b>SR 60X100_F</b>	101
<b>SR 60X125_S</b> <b>SR 60X125_F</b>	126
<b>SR 60X150_S</b> <b>SR 60X150_F</b>	151
<b>SR 60X200_S</b> <b>SR 60X200_F</b>	201
<b>SR 60X250_S</b> <b>SR 60X250_F</b>	251
<b>SR 60X300_S</b> <b>SR 60X300_F</b>	301
<b>SR 60X350_S</b> <b>SR 60X350_F</b>	351
<b>SR 60X400_S</b> <b>SR 60X400_F</b>	401

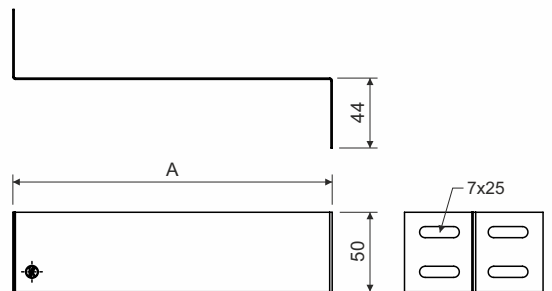

thickness of metal sheet: 1,0 mm

product description: The reduction is used to change the width of JUPITER cable trays or cable ladders.

Use the bolt NSM 6X10 for the connection. The bolt head should be inside the cable tray to protect the cables.

A bolt with a GMT surface finish is used for a tray with an F surface finish.

surface finish: S - Pre-Galvanized, zinc-layer 15 - 27 µm  
 F - Hot Dip Galvanized, zinc-layer 50 - 100 µm  
 EC - epoxy coating for indoor environment, - total paint, 60 µm

sales amount: á 1 pc

certification: EN 61537:02

classification: ČSN 73 0895 P90-R  
 DIN 4102-12 E90  
 STN 92 0205 PS 90

Fire classification is depend on the specific conditions of cable tray, detailed in the catalog Systems with maintain functionality in fire

storage: EN 60721-3-1

