

Clamp jaw nozzle brass

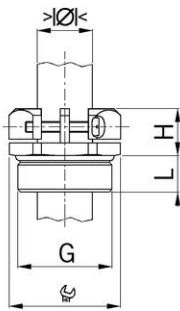

Entry thread metric

- Mechanical strain relief B

Order number:	1840.02
E-No:	121481808
EAN:	7611614134482
Material	Nickel-plated brass
Screws	Stainless steel A2
Operation temperature	-50°C / +300°C
Strain relief	Version B acc. to EN 62444
Protection class	IP 20
Entry thread	M40x1.5
Clamping range without insert min.	24.0 mm
Clamping range without insert max.	33.0 mm
Wrench size	46 mm
Dimension H	17 mm
Thread length L	13 mm
Dispatch	10