

Technical data sheet

Internal corner, asymmetrical, double, for Rapid 80 device
installation trunking, type GS-D90170
Item number: 6278340

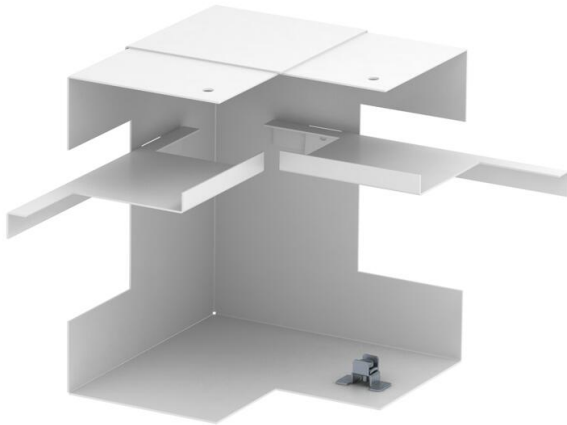

Internal corner for direct installation on GS device installation trunking.



St Steel

Master data

Item number	6278340
Type	GS-DI90170RW
Description 1	Internal corner
Description 2	simple, asymmetrical
Manufacturer	OBO
Dimension	90x170x148
Colour	Pure white; RAL 9010
Material	Steel
Smallest sales unit	1
Unit of quantity	Piece
Weight	71 kg
Weight unit	kg/100 pc.
CO2 Footprint (GWP) Cradle-to-Gate	3,2205 kg CO2e / 1 Piece

Technical data sheet

Internal corner, asymmetrical, double, for Rapid 80 device
installation trunking, type GS-D90170

Item number: 6278340



Dimensions

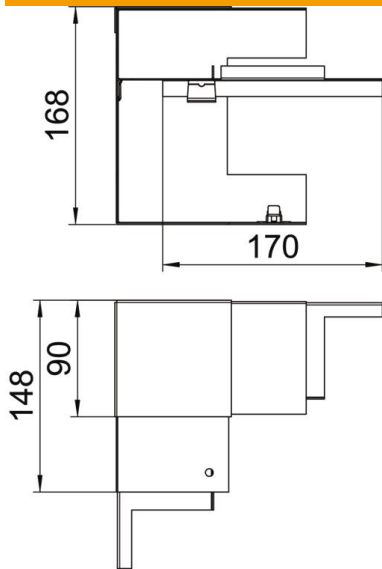

Length	148 mm
Width	170 mm
Height	90 mm

Technical data

Number of covers	2
Version for	Base
Shape	Asymmetrical
for duct dimension	90 x 170 mm
for duct width	170 mm
for trunking height	90 mm
Halogen-free	yes
Cable retaining clip	no
Duct connector	no
Cover mounting type	Internal
Mounting perforation in base	yes
Cover width	76.5 mm
Cover width 2	45 mm
Protection rating	IP30
Protective film	yes
Protection rating IK code	IK10
Permitted temperature range, max.	60 °C
Permitted temperature range, min.	-25 °C
Angle range, min.	90 mm